

BLDC PLANETARY GEAR MOTOR

28PXJG20K/BL2838



Product Specification and Usage--

1. Diameter 28MM planet gear reductor allows load 20kg.cm;
2. Adopt BLDC motor, adjustable-speed, CW/CCW
3. Applicable to less maintenance, low electromagnetic interference occasions

Dimensions

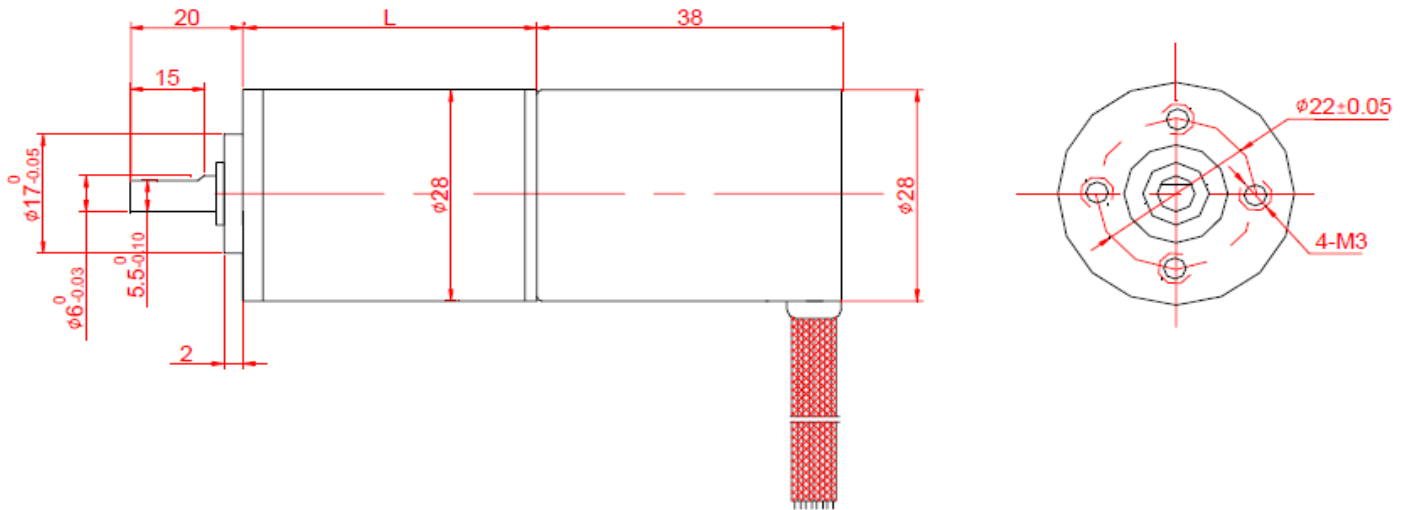

BLDC Motor Technical Data

TYPE	Rated voltage	No-load speed	No-load current	Rated speed	Rated torque	Output power	Peak torque
	VDC	r/min	A	r/min	g.cm	W	g.cm
BL2838-2430	24	3000	100	2100	70	1.5	200
BL2838-2440	24	4000	100	2800	80	2.3	200

BLDC Planetary Gear motor Technical Data

Complete model of configuration BL2838-2430 motor : 28PXJ20KG□G6D/ BL 2838-2430 (□Fill in reduction ratio)

Reduction ratio	3.7	5.2	14	19	27	51	71	100	139	189	264	369	516	720
Number of gear trains	1	1	2	2	2	3	3	3	3	4	4	4	4	4
Length(L1) mm	31.5	31.5	40.0	40.0	40.0	48.5	48.5	48.5	48.5	57.5	57.5	57.5	57.5	57.5
No-load speed r/min	809	579	214	158	111	59	42	30	22	16	11	8.1	5.8	4.2
Rated speed r/min	566	405	150	111	78	41	30	21	15	11	8.0	5.7	4.4	3.5
Rated torque kg.cm	0.2	0.3	0.8	1.1	1.5	2.6	3.6	5.1	7.1	8.7	12	17	20	20
Max. load kg.cm	6	6	12	12	12	30	30	30	30	60	60	60	60	60

Complete model of configuration BL2838-2430 motor : 28PXJG20K□G6D/BL2838-2430 (□Fill in reduction ratio)

Reduction ratio	3.7	5.2	14	19	27	51	71	100	139	189	264	369	516	720
Number of gear trains	1	1	2	2	2	3	3	3	3	4	4	4	4	4
Length(L1) mm	31.5	31.5	40.0	40.0	40.0	48.5	48.5	48.5	48.5	57.5	57.5	57.5	57.5	57.5
No-load speed r/min	1078	772	286	211	148	78	56	40	29	21	15	11	7.8	5.6
Rated speed r/min	755	541	200	147	104	55	39	28	20	15	11	7.6	6.2	4.6
Rated torque kg.cm	0.3	0.4	0.9	1.2	1.7	3.0	4.1	5.8	8.1	10	14	19	20	20
Max. load kg.cm	6	6	12	12	12	30	30	30	30	60	60	60	60	60

BLDC PLANETARY GEAR MOTOR

36PXJG30K/BL2838



Product Specification and Usage--

1. Diameter 36MM planet gear reductor allows load 30kg.cm;
2. Adopt BLDC motor, adjustable-speed, CW/CCW
3. Applicable to less maintenance, low electromagnetic interference occasions

Dimensions

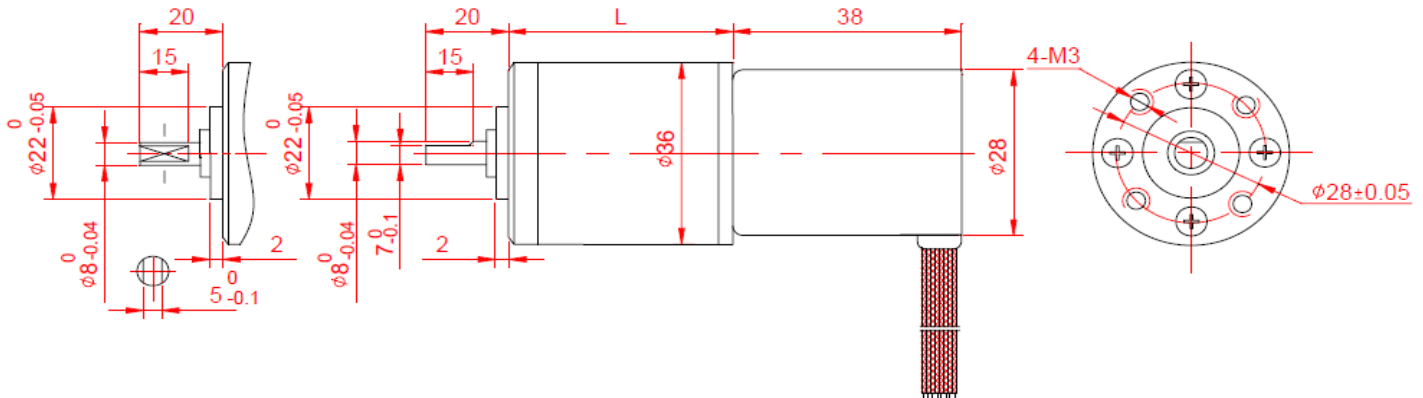

BLDC Motor Technical Data

TYPE	Rated voltage	No-load speed	No-load current	Rated speed	Rated torque	Output power	Peak torque
	VDC	r/min	A	r/min	g.cm	W	g.cm
BL2838-2450	24	5000	100	3500	80	2.9	250
BL2838-2460	24	6000	100	4200	80	3.4	250

BLDC Planetary Gear motor Technical Data

Complete model of configuration BL2838-2450 motor : 36PXJG30K□G8D/BL2838-2450 (□Fill in reduction ratio)

Reduction ratio	3.7	5.2	14	19	27	51	71	100	139	189	264	369	516	720
Number of gear trains	1	1	2	2	2	3	3	3	3	4	4	4	4	4
Length(L1) mm	31.5	31.5	38.5	38.5	38.5	48.5	48.5	48.5	48.5	55.5	55.5	55.5	55.5	55.5
No-load speed r/min	1348	965	357	263	185	98	70	50	36	26	19	14	9.7	6.9
Rated speed r/min	943	676	250	184	130	69	49	35	25	19	13	9.5	6.8	5.4
Rated torque kg.cm	0.3	0.4	0.9	1.2	1.7	3.0	4.1	5.8	8.1	10	14	19	27	30
Max. load kg.cm	9	9	30	30	30	60	60	60	60	90	90	90	90	90

Complete model of configuration BL2838-2460 motor : 36PXJG30K□G8D/BL2838-2460 (□Fill in reduction ratio)

Reduction ratio	3.7	5.2	14	19	27	51	71	100	139	189	264	369	516	720
Number of gear trains	1	1	2	2	2	3	3	3	3	4	4	4	4	4
Length(L1) mm	31.5	31.5	38.5	38.5	38.5	48.5	48.5	48.5	48.5	55.5	55.5	55.5	55.5	55.5
No-load speed r/min	1617	1158	429	316	222	118	85	60	43	32	23	16	12	8.3
Rated speed r/min	1132	811	300	221	156	82	59	42	30	22	16	11	8.1	6.4
Rated torque kg.cm	0.3	0.4	0.9	1.2	1.7	3.0	4.1	5.8	8.1	10	14	19	27	30
Max. load kg.cm	9	9	30	30	30	60	60	60	60	90	90	90	90	90

BLDC PLANETARY GEAR MOTOR

48PXJG50K/BL4260



Product Specification and Usage--

1. Adopt BLDC motor, adjustable-speed , CW/CCW
2. Planet gear hold is setup with needle bearing,increase load capacity effectively and last application life;
3. Applicable to less maintenance, low electromagnetic interference occasions

Dimensions

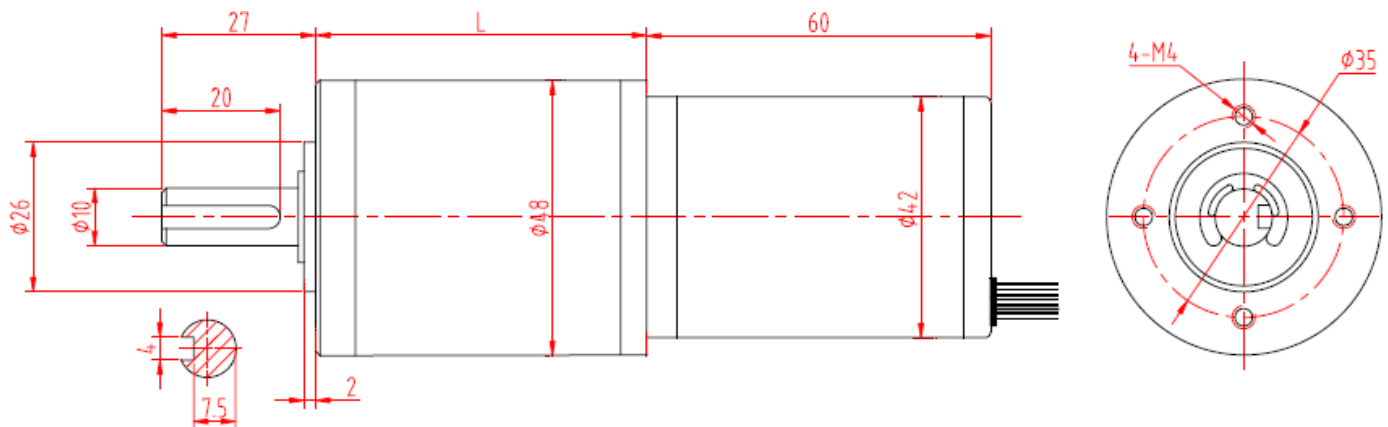

BLDC Motor Technical Data

TYPE	Rated voltage	No-load speed	No-load current	Rated speed	Rated torque	Output power	Peak torque
	VDC	r/min	A	r/min	g.cm	W	g.cm
BL4260-2440	24	4000	0.3	2800	0.7	20	1.8

BLDC Planetary Gear motor Technical Data

Complete model of configuration BL4260-2440 motor : 48PXJG50K□G10D/ BL4260-2440 (□Fill in reduction ratio)

Reduction ratio	15	19	24	56	71	91	116
Number of gear trains	2	2	2	3	3	3	3
Length(L) mm	42.5	42.5	42.5	52.5	52.5	52.5	52.5
No-load speed r/min	267	211	167	71	56	44	34
Rated speed r/min	187	147	117	50	39	31	24
Rated torque kg.cm	8.5	11	14	29	36	47	50
Max. load kg.cm	60	60	60	150	150	150	150

BLDC PLANETARY GEAR MOTOR

48PXJG200K/BL4260



Product Specification and Usage--

1. Adopt BLDC motor, adjustable-speed ,CW/CCW
2. Planet gear hold is setup with needle bearing, increase load capacity effectively and last application life;
3. Applicable to less maintenance, low electromagnetic interference occasions

Dimensions

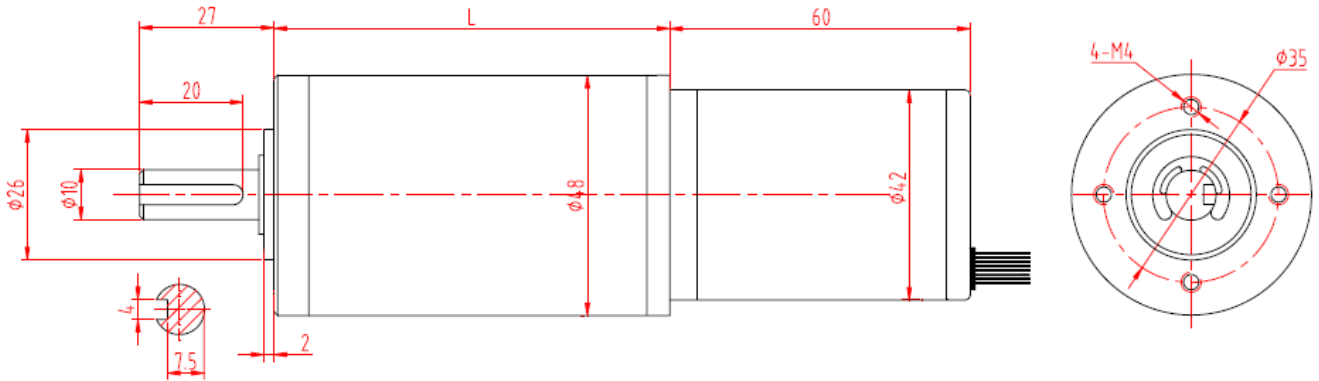

BLDC Motor Technical Data

TYPE	Rated voltage	No-load speed	No-load current	Rated speed	Rated torque	Output power	Peak torque
	VDC	r/min	A	r/min	g.cm	W	g.cm
BL4260-2420	24	2000	0.3	1400	0.7	8.6	1.8
BL4260-2430	24	3000	0.3	2100	0.6	13	1.8

BLDC Planetary Gear motor Technical Data

Complete model of configuration BL4260-2420 motor : 48PXJG200K□G10D/ BL4260-2420 (□Fill in reduction ratio)

Reduction ratio		944	1206	1540	2510
Number of gear trains		5	5	5	5
Length(L) mm		74.5	74.5	74.5	74.5
No-load speed r/min		2.1	1.7	1.3	0.8
Rated speed r/min		1.8	1.4	1.1	0.7
Rated torque kg.cm		200	200	200	200
Max. load kg.cm		600	600	600	600

Complete model of configuration BL4260-2430 motor : 48PXJG200K□G10D/ BL4260-2430 (□Fill in reduction ratio)

Reduction ratio		247	316	403	515
Number of gear trains		4	4	4	4
Length(L) mm		64.5	64.5	64.5	64.5
No-load speed r/min		12	9.5	7.4	5.8
Rated speed r/min		8.5	6.6	5.2	4.1
Rated torque kg.cm		98	125	160	200
Max. load kg.cm		600	600	600	600

BLDC PLANETARY GEAR MOTOR

60PXJG300K/BL5778



Product Specification and Usage--

1. Adopt BLDC motor, adjustable-speed ,CW/CCW
2. Planet gear hold is setup with needle bearing, increase load capacity effectively and last application life;
3. Applicable to less maintenance, low electromagnetic interference occasions

Dimensions

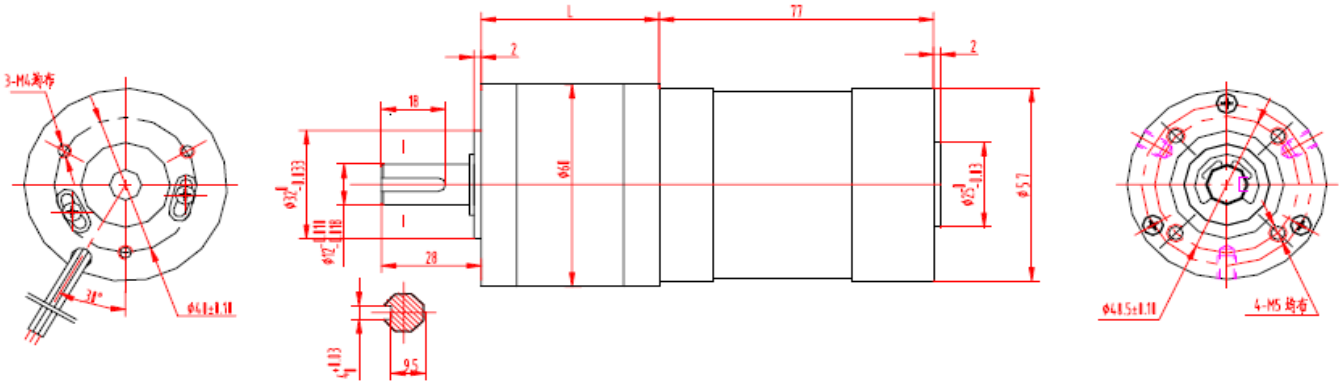

BLDC Motor Technical Data

TYPE	Rated voltage	No-load speed	No-load current	Rated speed	Rated torque	Output power	Peak torque
	VDC	r/min	A	r/min	g.cm	W	g.cm
BL5778-2420	24	2000	450	1200	3000	40	2.8
BL5778-2430	24	3000	400	2000	3000	60	4

BLDC Planetary Gear motor Technical Data

Complete model of configuration BL5778-2420 motor : 60PXJG300K□G12D/ BL5778-2420 (□Fill in reduction ratio)

Reduction ratio	3.6	4.25	13	15	18	47	55	65	76
Number of gear trains	1	1	2	2	2	3	3	3	3
Length(L) mm	46.0	46.0	46.0	46.0	46.0	57.5	57.5	57.5	57.5
No-load speed r/min	555	470	154	133	111	42	36	30	26
Rated speed r/min	333	282	92	80	66	25	22	18	16
Rated torque kg.cm	10	12	30	41	49	120	140	166	194
Max. load kg.cm	30	30	100	100	100	300	300	300	300

Complete model of configuration BL5778-2430 motor : 60PXJG300K□G12D/ BL5778-2430 (□Fill in reduction ratio)

Reduction ratio	3.6	4.25	13	15	18	47	55	65	76
Number of gear trains	1	1	2	2	2	3	3	3	3
Length(L) mm	46.0	46.0	46.0	46.0	46.0	57.5	57.5	57.5	57.5
No-load speed r/min	833	706	230	200	167	64	54	46	39
Rated speed r/min	555	470	154	133	111	42	36	30	26
Rated torque kg.cm	10	12	30	41	49	120	140	166	194
Max. load kg.cm	30	30	100	100	100	300	300	300	300

China Electric motor Association

GuangDong M&C Electric Power Co.Ltd

Add:6/f dizhi Building NO.739 Dongfeng Rd.E Guangzhou China P.C.:510080

<http://www.china-electricmotor.com>

E-mail:mc@china-electricmotor.com

Tel:+86 2089660216

Fax:+86 2089660219